

HOVEROUND BATTERY REPLACEMENT MPV4/MPV5

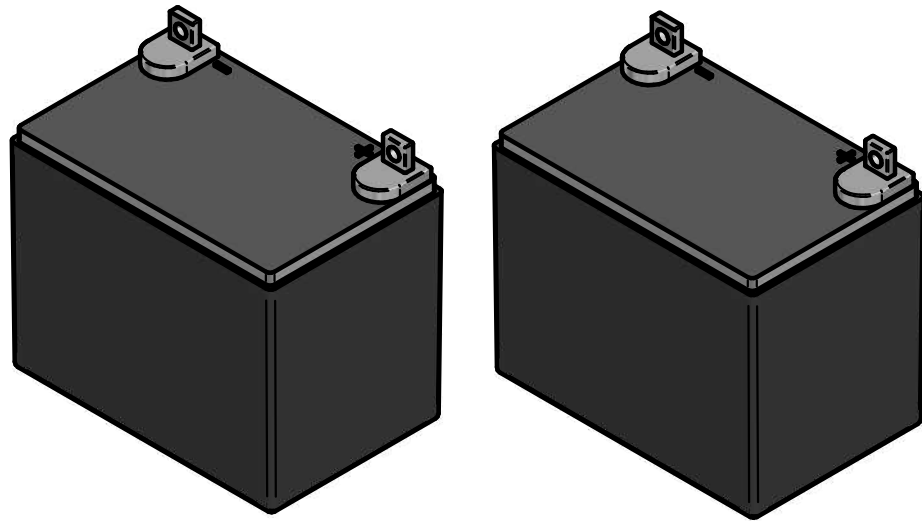

ITEM 1 - BATTERY

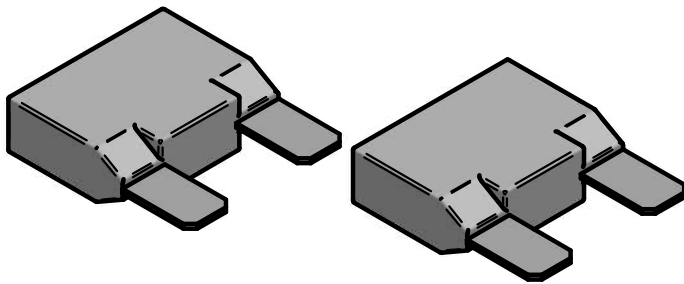

ITEM 2 - FUSE

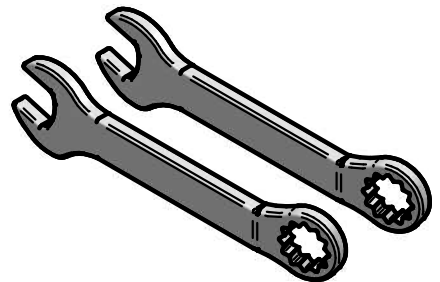

ITEM 6 - WRENCH

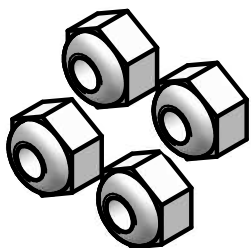

ITEM 3 - LOCK NUT

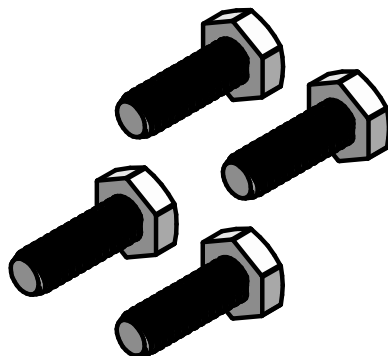

ITEM 4 - BOLT

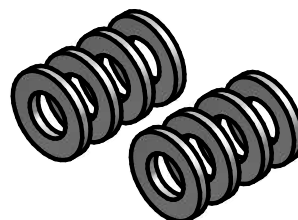

ITEM 5 - WASHER

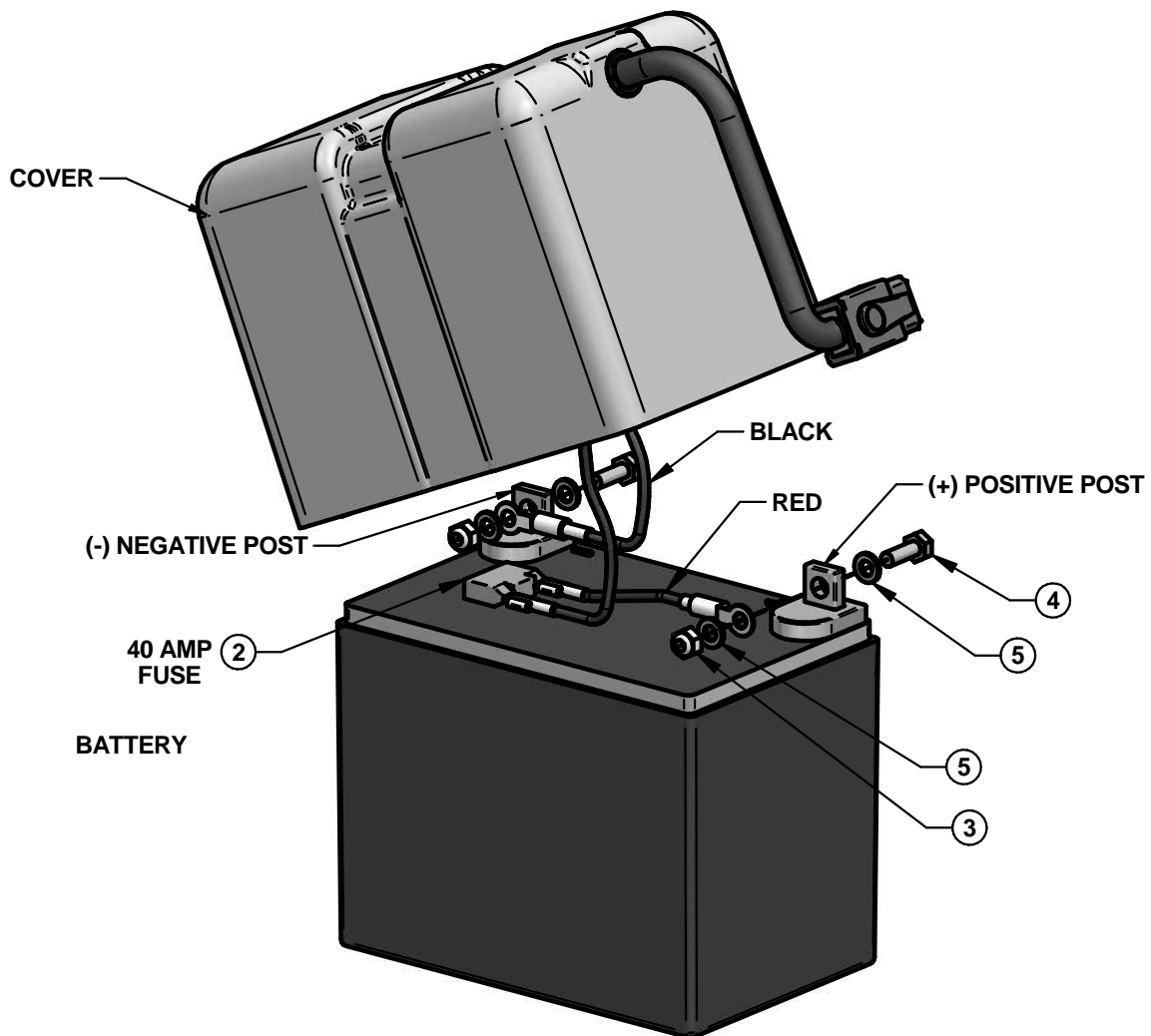
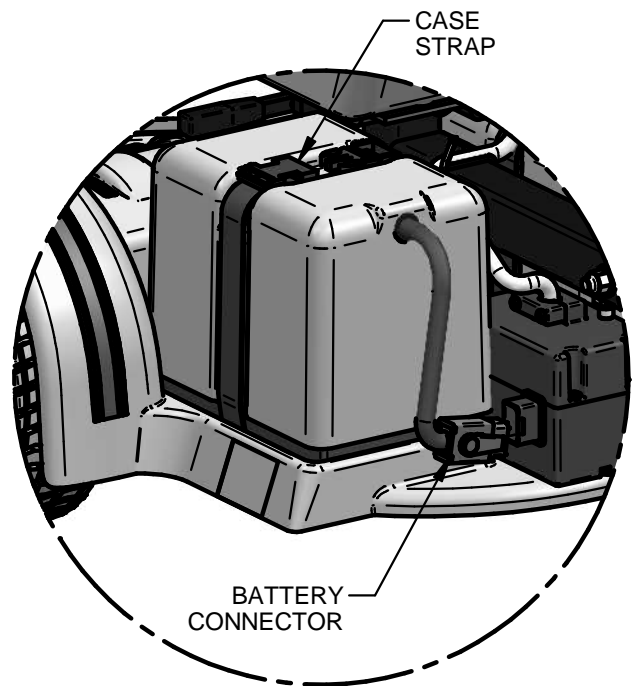
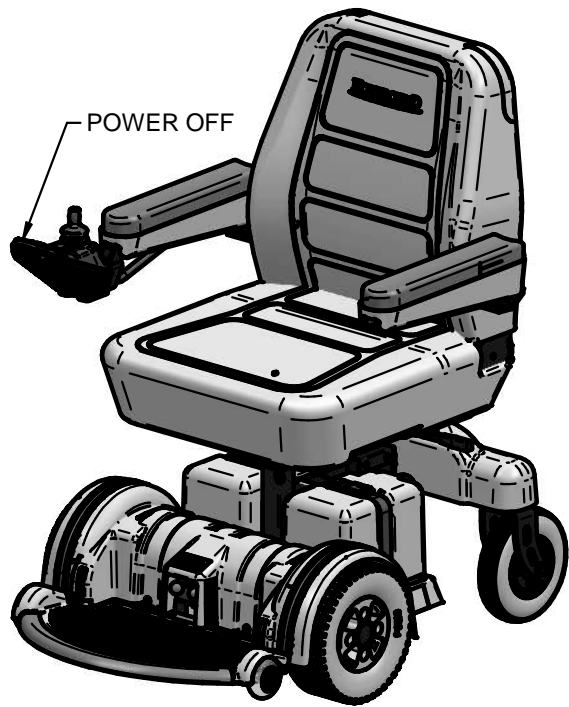

FIG. C

WARNING

To avoid serious injury or death:

- Completely read and follow all warnings about the batteries in this instruction sheet and in the user instruction manual and labels applied to the battery and product. Failure to do so could result in fire, explosion, injury and/or death.
- Batteries contain sulfuric acid. Use extreme caution when handling batteries. To prevent burn injury, use proper protective gear such as gloves and safety glasses when handling batteries
- NEVER attempt to open a sealed battery.
- Battery posts contain lead. The battery contains corrosive chemicals. ALWAYS wash your hands after handling any part of the battery.
- Batteries are heavy. Use proper lifting and handling practices to prevent dropping, pinching or lift related injuries.
- ALWAYS make sure the protective cover is installed and all battery connections and screws are tight before using your power wheelchair.
- Batteries emit explosive gas – DO NOT smoke or have open flame around batteries. Operate your power wheelchair in well ventilated areas only.
- When handling and /or working with batteries, do not allow metal objects such as tools, jewelry, trunk lids, and toolboxes to touch the battery terminals as it can cause explosive sparks or fire.
- ALWAYS store batteries in an upright position.
- NEVER use a battery that has been frozen or might have been frozen.
- Do not connect any devices, medical or otherwise, to the batteries or electrical system except those supplied by Hoveround.
- ALWAYS use batteries of the same type and capacity for this power wheelchair.
- NEVER connect life support systems or auxiliary devices to your wheel chair battery. The electrical system may fail and causes sever injury and/or death.
- ALWAYS refer to the supplied wiring diagram when installing the batteries.
- ALWAYS install the correct fuse as specified in the instruction sheet. This will prevent battery and wire overload.
- ALWAYS dispose of batteries in accordance with EPA regulations.
- Be careful not to touch the wrenches or wires across the battery terminals. A dangerous short circuit and sparking may occur and may burn or harm you or cause an explosion.

BATTERY REMOVAL AND INSTALLATION INSTRUCTION

STEP 1 – CHECK PARTS CONTENT OF REPAIR KIT TO MAKE SURE ALL PARTS ARE PRESENT.

STEP 2 – TURN POWER OFF ON THE JOYSTICK CONTROLLER (FIG. A)

STEP 3 – UNPLUG THE BATTERY CONNECTORS FROM THE JUNCTION BOX AND REMOVE THE BATTERY ASSEMBLY FROM THE BASE (FIG. B)

STEP 4 – AFTER REMOVAL FROM THE BASE, PLACE THE BATTERY ASSEMBLY ON A STABLE SURFACE AND UN-SNAP THE CASE STRAP (FIG. B). SLIDE THE COVER BACK TO EXPOSE THE BATTERY TERMINALS (FIG. C)

STEP 5 - USING 7/16" WRENCHES (ITEM 6), LOOSEN AND REMOVE THE 7/16" BOLTS (ITEM 4) NUTS (ITEM 3) AND WASHERS (ITEM 5) HOLDING THE BATTERY CABLES TO THE BATTERY POST. KEEP TOOLS AND OTHER METAL OBJECTS FROM TOUCHING THE (+) AND (-) POST'S, SEE WARNINGS. NOTE THE POSITION OF THE BATTERY CABLES AND FUSE FOR REINSTALLATION.REPLACE THE FUSE IF DAMAGED OR BLOWN.

STEP 6 – ON THE NEW BATTERY, INSTALL THE BATTERY CABLES AND FUSE (ITEM 2) IN THE SAME PLACE AS ON THE OLD BATTERY. MAKE SURE THE BLACK WIRE IS CONNECTED TO THE (-) NEGATIVE POST AND THE RED WIRE IS CONNECTED TO THE (+) POSITIVE POST (FIG. C)

STEP 7 – REINSTALL THE BATTERY COVER OVER THE BATTERY. MAKE SURE THE BATTERY CABLES ARE NOT PINCHED BETWEEN THE COVER AND THE BATTERY AND ARE ROUTED THRU THE COVER HOLE AND GROMMET WITHOUT BINDING. THERE SHOULD BE APPROXIMATELY 8 ½ INCHES OF CABLE OUTSIDE OF THE COVER TO THE END OF CONNECTOR WHEN PROPERLY INSTALLED.

STEP 8 – REINSTALL THE BATTERY COVER STRAP AROUND THE BATTERY AND COVER.

STEP 9 –INSTALL THE BATTERY CASE ASSEMBLY ON THE POWER CHAIR BASE AND PLUG THE CABLES INTO THE JUNCTION BOX. THE CABLES SHOULD PLUG INTO THE JUNCTION BOX WITHOUT BINDING OR PULLING.